



LG-XPEX LED SERIES

EXPLOSION PROOF EDGE LIT LED EXIT LIGHT

Features

- Emergency battery back-up integral to sign (no additional enclosure required)
- 3-hour emergency operation
- Optional battery back-up self-diagnostic feature
- Field replaceable LED circuit boards and drivers with quick disconnects
- Edge-lit sign



Additional Features

- Wall, pendant and end mounting options
- Alternate exit legend and languages available
- Single- or double-sided option
- Sealed NiCad batteries
- Provided with three (3) 1/2" NPT hubs
- Red or green LED options

Classifications

- Class I, Division 1, Groups C & D
- Class II, Division 1, Groups E, F & G
- Class III
- Class I, Zone 1, Groups IIA, IIB
- Zone 2, Groups IIA, IIB + H2 & IIC
- UL 844 Hazardous Locations
- UL 1598A Marine Outside Type
- Temperature Class (T-Rating)-T6
- Patent No. 7,287,347
- IP65

Standard Materials

- Body: A356T6 aluminum (less than .4% copper content) with baked-on gray epoxy finish
- Gasket: One-piece neoprene
 - Sign: Acrylic
 - Hardware: Stainless steel

Dimensions

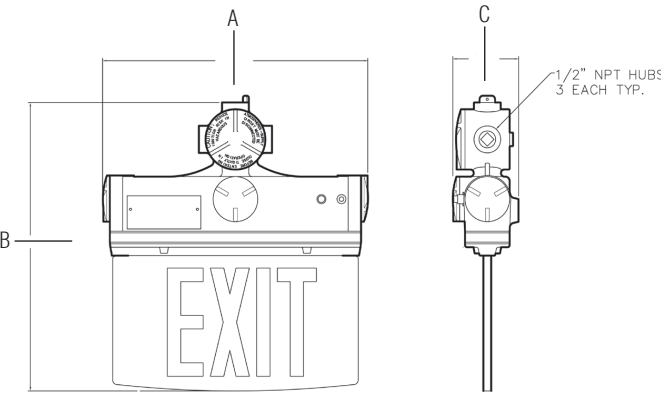

SERIES	DIMENSIONS (INCHES)			BOXED WEIGHT	SHIPPING VOLUMEN (BOXED FIXTURES)
	A	B	C		
LG-XPEX	14.88	3.69	16.00	14 Lbs	1.24 cu. ft

MAXIMUM INPUT POWER	
Red no battery	1.5 Watts
Red with battery	2.5 Watts
Green no battery	2.3 Watts
Green with battery	3.0 Watts

OPERATING TEMPERATURE RANGE	
Temperature Rating - T6	
Red Legend	+10°C Minimum to +55°C Maximum
Green Legend	+10°C Minimum to +40°C Maximum

How To Order

Sample Part Number: LGXPEX-2-G-DT-WP-XX

SERIES	NUMBER OF FACES	LEGEND COLOR	VOLTAGE FREQUENCY	MOUNTING	OPTIONS
LGXPEX	1= Single Face	R= Red	DT = 120/277V 60HZ	WP = Wall/Pendant Mounting	EM = Emergency Battery Backup
					EU = Green Running Man Exit
					SD = Self Diagnostics
	2= Single Face	G= Green	24 = 220-240V 50/60HZ	EB = End Bracket	X = Exit Legend in Other Languages
			Other voltages available - consult factory		Language Must Be Specified